

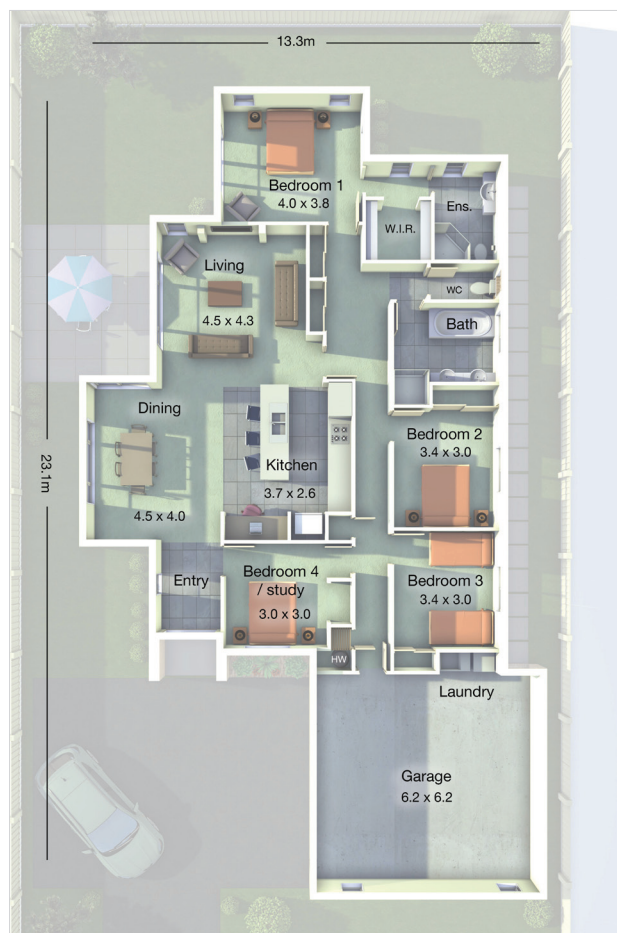

## Intelligent design, clever use of space and a fresh light ambience are trademarks of the CLARKVILLE.

A home for those who love entertaining, and those who love to be pampered. With children's rooms at the front and the master suite at the rear, parents can look forward to some peace and relaxation after a busy day. The other three bedrooms are sensibly arranged from the open plan kitchen, dining and family areas to optimize privacy. This home delivers on its promises to satisfy your family's needs.

- House 208m<sup>2</sup>
- 10 year Masterbuild warranty
- Clay brick exterior
- Long run Coloursteel roof
- Carpets, vinyl and tiles
- Stainless appliances
- Fujitsu heat pump

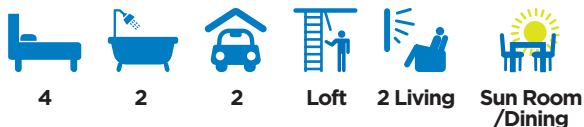

CONTACT US ►

Office: 03 920 1001  
 Tony Andersen: 027 255 0001  
 Christine Andersen: 027 252 0001  
[info@trendsetterhomes.co.nz](mailto:info@trendsetterhomes.co.nz)  
[www.trendsetterhomes.co.nz](http://www.trendsetterhomes.co.nz)

## FEATURING

- 10 year Registered Masterbuilders guarantee
- NZRMBA plain language contract
- Exterior/Interior Colour Consultation
- Engineer designed foundation
- RIB RAFT foundation
- Council Building Consent fees only
- Quality machined timber framing
- Midland clay brick veneer or plaster as pictured
- Corrugated colour steel roof & ridging
- Colour steel fascia & gutter system
- 13mm Gib board to all internal ceilings
- 10mm Gib board to all internal walls
- Gib Aqualine to bathroom ensuite
- Aluminum front entry door
- Quality door handles by Windsor
- Double glazed windows to house *excluding garage*
- 50" flat screen TV & aerial
- LED interior lighting upgrade
- Sectional garage door with auto opener – 2 remotes
- Mains 300 litre hot water cylinder
- 3 exterior hose taps
- Tiled entry & wet areas
- Heavy duty [grade 2] carpet throughout
- Chromed heated ladder towel rail in bathroom & ensuite
- Quality kitchen inc 38mm tops, s/s bowl inc drainer
- Panasonic inbuilt microwave with trim kit
- Whirlpool stainless steel oven, ceramic hobb, dishwasher & matching hood
- Bosch double door icemaker fridge/freezer
- Quality tapware – *a range of styles to choose from*
- Wall mounted vanities as per plan
- 3 telephone outlets
- HPM electrical plugs & switches inc metal face plates
- LED exterior lighting
- 3 coat Resene paint finish throughout
- Fujitsu high wall heat pump air conditioner